

BLOCK C

Floor Plan

Commercial Floor Plan

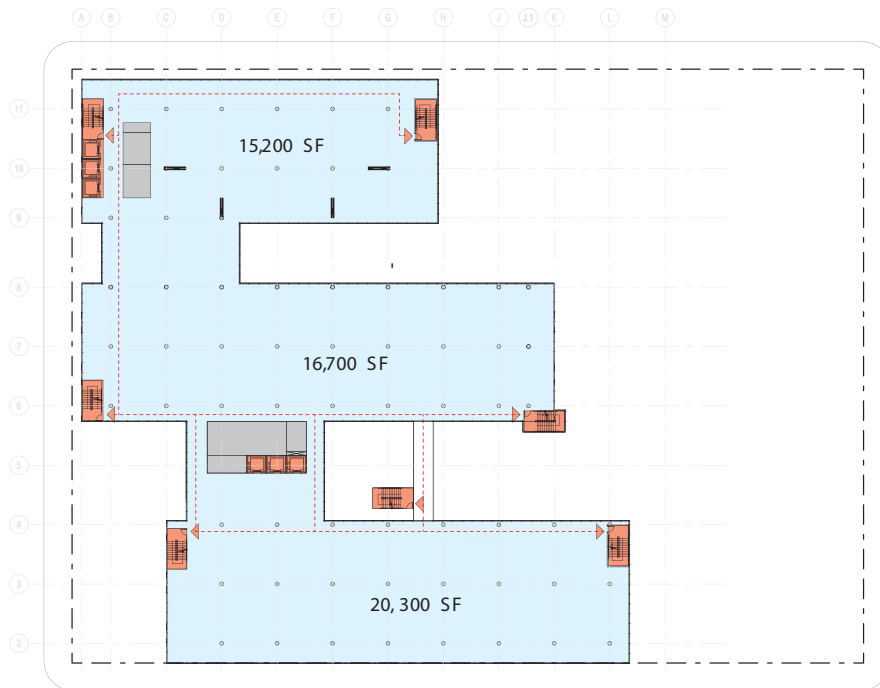

Office Floor Plate Full Build Out: 52,000 SF

- State-of-the-art 700,000 SF high rise development with large peninsula floor plates ideal for large corporate users and multi-tenant office tenants
- The building features 10 foot finished ceilings 15 foot slab to slab height and abundant light from the peninsula style design
- Ample opportunity to exterior space, amphitheaters, balconies and access to the Makers Plaza
- Immediately adjacent to the historic coliseum and food hall venue featuring neighborhood and destination retail
- 1.5 per 1,000 parking